

Awasi
MENDOZA

Mendoza

MENDOZA, ARGENTINA

RELAIS &
CHATEAUX



CHILE

ARGENTINA

Awasi
MENDOZA

Location

Awasi Mendoza is strategically located on a 55-acre (22 hectares) property in the heart of Luján de Cuyo, just 30 minutes south of Mendoza city. The property is perfectly positioned between some of the region's most renowned wineries and the majestic Andes Mountains, offering breathtaking views of snow-capped peaks. The Luján de Cuyo region is known for housing some of Argentina's most prestigious wineries, making it the ideal location for an authentic wine experience. The property is situated amidst lush vineyards, providing an atmosphere of tranquility and privacy, surrounded by the natural beauty of Argentina's most important wine region.

How to get there

Access to Awasi Mendoza is through Governor Francisco Gabrielli International Airport (MDZ), located in Mendoza. The airport receives direct flights from Buenos Aires (1h45 flight), Santiago de Chile, Lima, São Paulo, Panama and international connections through Buenos Aires to destinations such as Miami, and Europe. From the airport, it's just a 45-minute transfer to the lodge, crossing Mendoza's wine landscape. For guests coming from Buenos Aires, it's also possible to choose regular domestic flights operated by airlines such as Aerolíneas Argentinas and JetSmart, with multiple daily frequencies.

MENDOZA

A brief history

Awasi Mendoza is the first lodge of its kind in South America, conceived as a tribute to Mendoza's rich winemaking tradition. As the newest addition to the Awasi Lodges Group and a proud member of Relais & Châteaux, it was named Argentina's #1 resort and #3 resort in South America by Travel + Leisure magazine in 2025.

The lodge was developed with the pioneering concept of fully integrating luxury hospitality with authentic wine experiences, creating a unique destination that celebrates Argentine wine culture in an environment of sophistication and natural elegance.



Our Lodge

Awasi Mendoza is a 17-room property situated on 55 acres (22 hectares) of vineyards. The lodge features Spanish colonial-inspired architecture that harmonizes perfectly with the surrounding natural landscape. The property boasts an exclusive wine cellar with carefully selected wines, combining regional and labels from all over Argentina.

The lodge's design prioritizes integration with the natural environment, providing panoramic views of the Andes and surrounding vineyards.

Why Awasi?

Because we have a dedicated team committed to catering to your preferences: what sets us apart is our attention to detail.

Because Awasi is the only hotel in South America that offers a service that is 100% tailor-made.

Because our Relais & Châteaux cuisine stands out for its flavours and textures, featuring regional ingredients and is adapted to the needs of each guest.

Our Villas

Each of Awasi Mendoza's Villas has been designed as a private retreat, combining contemporary elegance with exceptional comfort. All rooms are equipped with a fireplace and private pool, creating a perfect environment for relaxation and contemplation. Each Villa features an exclusive terrace, strategically positioned to provide spectacular sunset views over the Andes or intimate moments such as a special outdoor breakfast. The Villas, moreover, have a private hot tub.

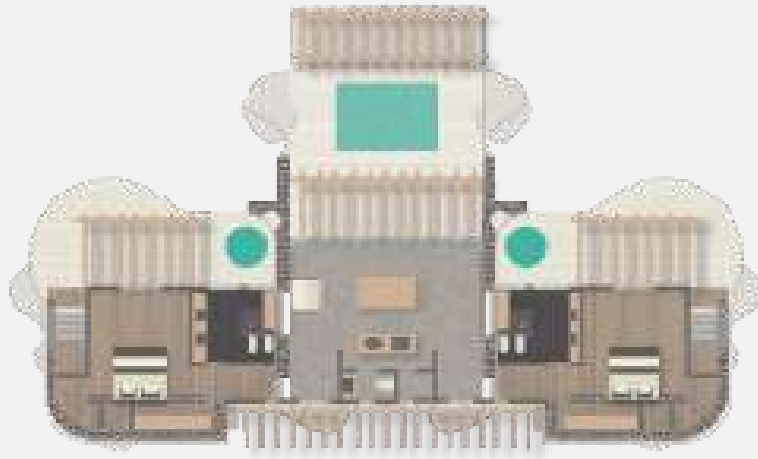



Our Cuisine

Awasi Mendoza's gastronomic experience celebrates the authentic flavors of the region, using fresh, seasonal ingredients grown in our own organic garden. The culinary philosophy is based on using high-quality local products, from argentine meats to vegetables and herbs grown on the property. The restaurant offers a contemporary interpretation of argentine cuisine, perfectly harmonizing dishes with the region's exceptional wines.

A photograph of two riders on horseback, silhouetted against a bright sky, riding through a vineyard. The scene is framed by large, dark trees in the foreground, creating a sense of depth and tranquility. The riders are positioned in the lower center of the frame, moving away from the viewer. The background shows rows of grapevines and a clear sky.

Thought for you

Prior to your arrival at Awasi, we will ask you to complete a short questionnaire to inform us of your preferences, special interests, physical conditions, dietary requirements, and any other details that will help our team arrange an unforgettable trip, specially designed for you.

Our Excursions

Awasi Mendoza offers a variety of exclusive experiences that allow guests to discover Mendoza's cultural and natural richness. Horseback rides lead guests through vineyards, providing a unique perspective of the landscape. Winery visits include special lunches at selected properties, accompanied by guided tastings. Exclusive wine-tasting sessions also take place in the lodge's own cellar.

Guests can take part in cooking classes to learn how to prepare traditional empanadas, enjoy live tango performances that reflect the Argentine spirit, and during the appropriate season, join the olive harvest, followed by tastings of artisanal olive oil produced at the lodge. For those seeking adventure, the lodge offers trekking and hiking excursions to destinations such as Aconcagua and C ndor Lookout Trail.



MENDOZA

Weather

Mendoza has a dry continental climate with more than 300 sunny days per year, characterized by large thermal amplitudes between day and night.

Average Temperatures

During summer (December to March):

Maximum temperatures vary between 28°C (82°F) and 32°C (90°F) during the day.

Autumn (March to June):

Offers the ideal climate for visits, with daytime temperatures between 20°C (68°F) and 25°C (77°F) and nights from 8°C (46°F) to 12°C (54°F).

Winter (June to September):

Presents maximum temperatures of 15°C (59°F) to 18°C (64°F) and minimum temperatures that can reach -2°C (28°F), especially during dawn.

Spring (September to December):

Brings gradually milder temperatures, from 18°C (64°F) to 25°C (77°F) during the day.

What to pack

Due to thermal amplitude, it's recommended to bring layered clothing, including light jackets for nights, even in summer. It's essential to include high-protection sunscreen, hat, and sunglasses due to the intense solar radiation at altitude.



Contact

Make your #AwasiExperience
come true.

For reservations please contact us via the
following options:

Tel: +(56-2) 2233-9641

info@awasi.com

Toll Free

CHILE

+56 2 2368-1882

ARGENTINA

+54 261-476-0867

BRAZIL

+55 11 4210-8364

US

+1 877-686-4345

AUSTRALIA

+61 290-991-627

UK

+44 20 3769-8351

AWASI.COM

